



Project Information

Diamantlaan

Diamantlaan 10
Hoofddorp

To let

Warehouse space with office unit at business park Graan voor Visch in Hoofddorp

Diamantlaan 10 Hoofddorp

Project description

Warehouse space of approx. 1,420 sq m with simple modular office space on the floor. The available space on the ground floor is provided with a persons entrance, 3 overhead doors, sanitary facilities and a pantry. The building benefits from ample surrounding private ground for loading/unloading and passenger parking.

Location

Business park Graan voor Visch offers excellent access from major roads A4/A44/A5 (Amsterdam – Dan Haag – Rotterdam). The shopping centre of Hoofddorp is only a few car minutes away. The NS train station Hoofddorp lies at a short distance, ensuring great access by train and nearly every bus that comes through the station. The “Zuidtangent” express bus also has two stops on the edge of the business park. This high speed (mostly dedicated bus lane) service connects Haarlem (via Schiphol) to Amsterdam-Zuidoost (line 300) and Nieuw-Vennep to Schiphol Airport and Amsterdam- Zuid WTC (line 310) and guarantees perfect access via public transport. For further information about the Zuidtangent, go to www.connexion.nl.

Surface area

The warehouse space has a total surface area of approx. 1,420 sq m with a simple modular office unit on the floor.

Parking

Parking places are available on private ground.

State of delivery

The warehouse space features include:

- persons entrance with a reception desk;
- sanitary facilities and pantry on the ground floor;
- simple office space on the floor;
- 3 overhead doors;
- gas heater;
- roof lights;
- smooth finish concrete floor;
- sky lights.

Rental price

The rental price is € 65,- per sq m per year excluding VAT and service charges.

Lessor and Lessee explicitly declare that in determining the rent, the rent level is based on the starting point that Lessee will permanently utilise a minimum percentage as determined by law (or at a later stage to be determined) of the leased space for purposes giving rise to VAT deductions, so that taxed rent may be opted for.

Service charges

The service charges are € 12,50 per sq m per year excluding VAT as an advanced payment with a yearly settlement based on actual cost.

Acceptance

To be agreed upon.

Although BT Makelaars takes due care in compiling all information provided , the accuracy of the content cannot be guaranteed and no rights or obligations can be derived from the information provided.





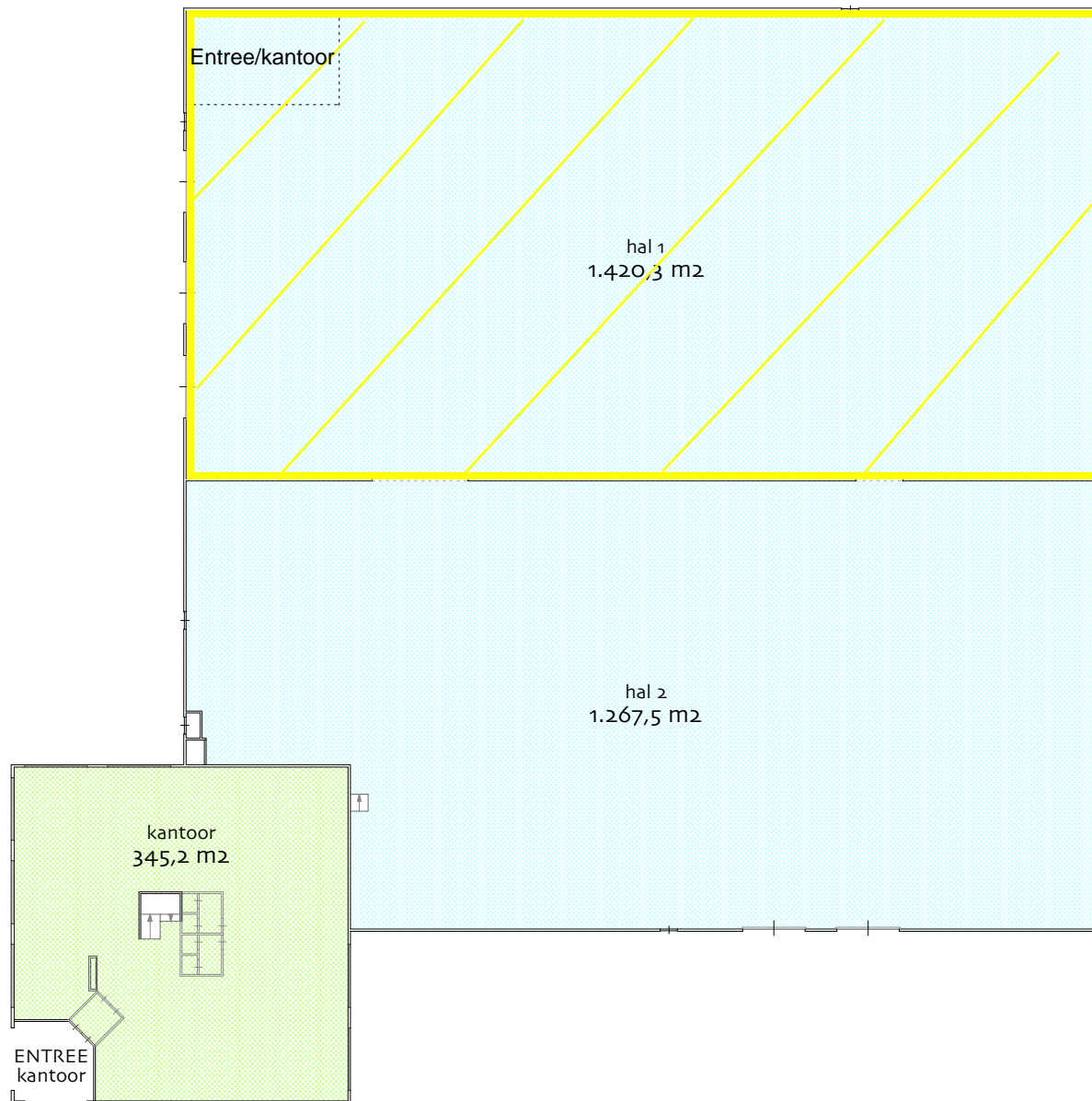

object: Diamantlaan 10
 plaats: Hoofddorp
 datum: 27 maart 2017
 betreft: verhuurbare vloeroppervlakte
 VVO conform NEN 2580
 schaal: 1:400

AeQO Property Support BV | www.aeqo.nl

NB: semi-permanente constructies zijn buiten beschouwing gelaten

verhuurbare vloeroppervlakte VVO		
VVO kantoor		345,2 m ²
VVO bedrijfsruimte		2.687,8 m ²
VVO totaal		3.033,0 m ²

begane grond