

Gebouw B1

Plattegrond: Begane Grond

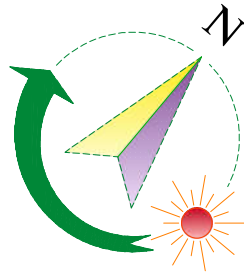

Toewijzing Primair oppervlak aan:

Huurder A	Huurder B	Huurder C	Huurder D	Huurder E	Huurder F

Direkt	
Raio	
Geen	

Gemeenschappelijke doorbelasting Gebouw (Ratio% Huurders)	
Gemeenschappelijke doorbelasting verdieping (Ratio% Huurders)	
Niet verhuurbaar deel gebouw	

Royal HaskoningDHV
Enhancing Society Together

Leidende 4, Utrecht
Postbus 2302, 3500 GE Utrecht
(085) 484 4432 (tel)
(085) 484 4433 (fax)
info@haskoningdhv.com
christian.peperkamp@haskoningdhv.com

Metercertificaat

OPDRACHTGEVER : **Morevent. B. V.**
Chrysaanhemumlaan 9
2106 BM Heemstede

PROJECT : **Plattegronden**
Boeingavenue 285 (Gebouw B1)
Schiphol-Rijk

ONDERNEEMER	: Nem:8580 Begane Grond Huurders	PROJECTNUMMER	BF2850-192
MR. A	MR. G	FILENNAAM (CAD)	192-756-H00
MR. B	MR. H	FORMAAT	A1
MR. C	CP / SH	DATUM	SCHAL
MR. D	MR. X	10-11-2023	1:100
MR. E	MR. L		
MR. F			

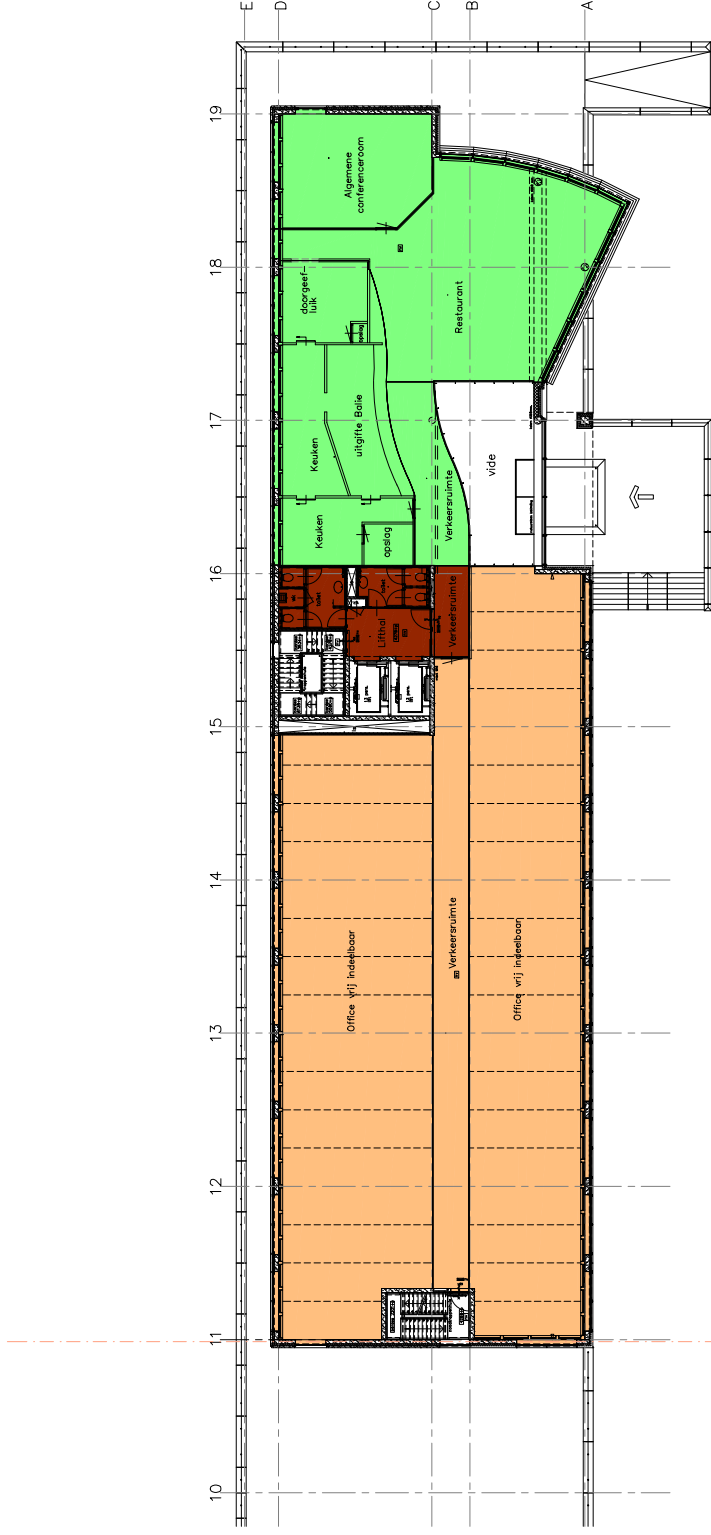

Gebouw B1

Plattegrond: Verdieping 1

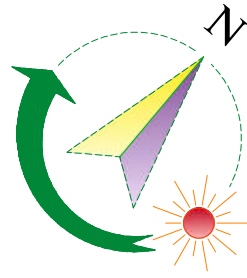

Toewijzing Primair oppervlak aan:

Huurder A	Huurder B	Huurder C	Huurder D	Huurder E	Huurder F
Direkt	Raio	Geen			

	Gemeenschappelijke doorbelasting Gebouw (Ratio% Huurders)			
	Gemeenschappelijke doorbelasting verdieping (Ratio% Huurders)			
	Niet verhuurbaar deel gebouw			

 Royal HaskoningDHV Enhancing Society Together		Meesterplaat A		 DE VERRIJME DIETER	
Leidschewer 4, Utrecht Postbus 2302, 3500 GE Utrecht (031) 84 44 33 (tel) 031 84 44 33 (fax) 031 84 44 33 (mob) d.h.v.in@rhh.nl / rhh.nl					
OPRACHTGEVER : Morevent t. B.V. Chrysaanhemumlaan 9 2106 BM Heemstede					
PROJECT : Plattegronden Boeingavenue 285 (Gebouw B1) Schiphol-Rijk					
ONDERNEEMER : Nem:850 Verdieping 1 Huurders		PROJECTNUMMER : BF2850-192		FEILNUMMER (CAD) : 192-756-H01	
W.B. A :	W.B. B :	W.B. C :	W.B. D :	W.B. E :	W.B. F :
NIEMEN/ADRES/US : CP / SH		F.ARM/AAT : AI		SCHAAL : 1:100	
DATUM : 10-11-2023		CERTIFICAAT NR : 756-H2			

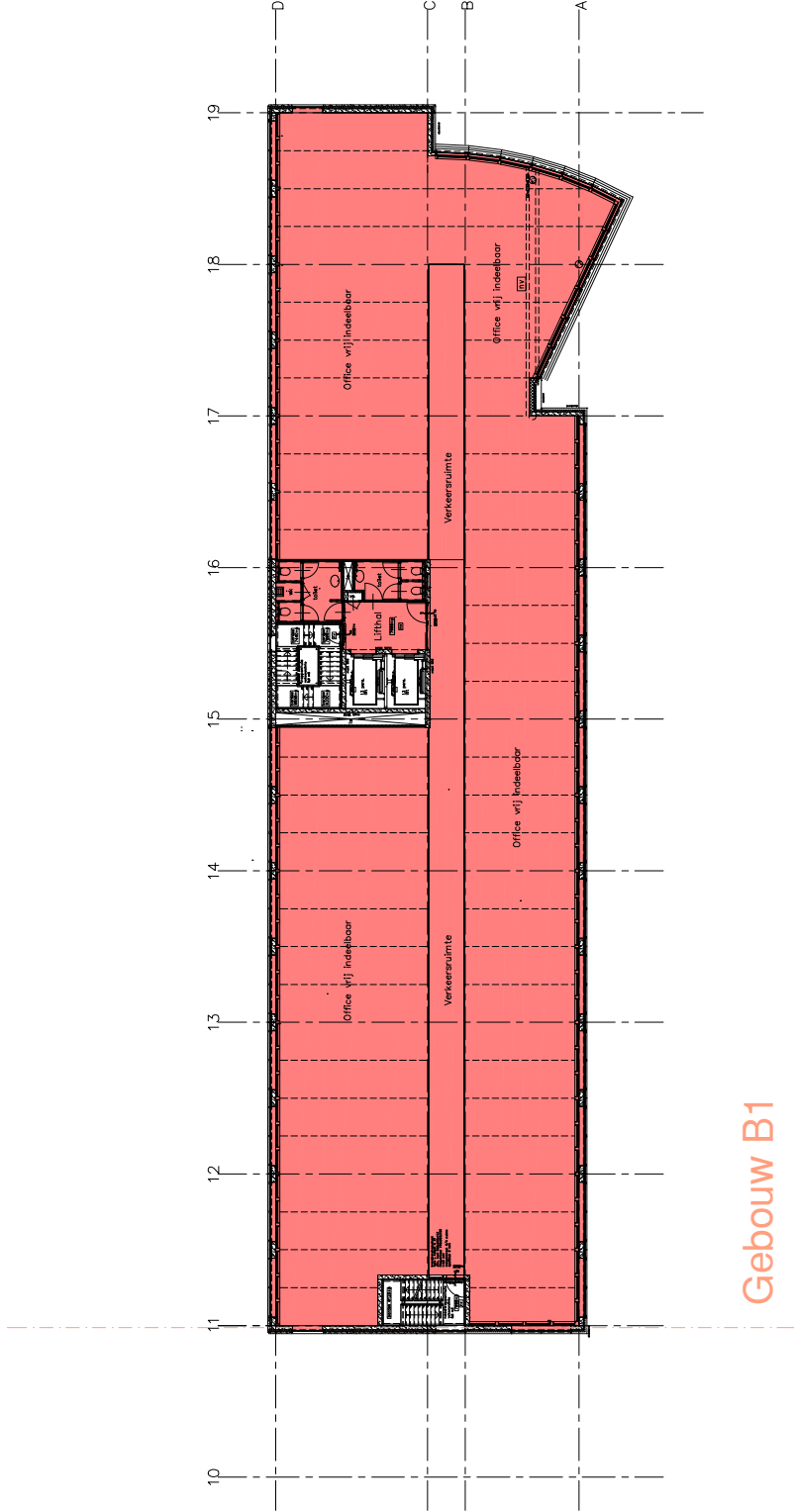

Gebouw B1

Plattegrond: Verdieping 2

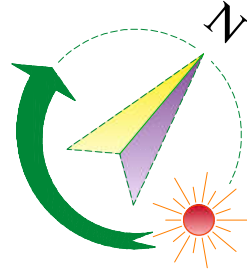

Toewijzing Primair oppervlak aan:

Huurder A	<input type="checkbox"/>	Gemeenschappelijke doorbelasting Gebouw (Ratio% Huurders)	<input type="checkbox"/>
Huurder B	<input type="checkbox"/>	Gemeenschappelijke doorbelasting verdieping (Ratio% Huurders)	<input type="checkbox"/>
Huurder C	<input type="checkbox"/>	Niet verhuurbaar deel gebouw	<input checked="" type="checkbox"/>
Huurder D	<input type="checkbox"/>		
Huurder E	<input type="checkbox"/>		
Huurder F	<input type="checkbox"/>		

Leidschewer 4, Utrecht
Postbus 2302, 3500 GE Utrecht
(085) 484 432 (tel)
(085) 484 449 (mob)
christian.peperkamp@rhdhv.com

Metercertificaat

DE VERRIJME METER

OPDRACHTGEVER : **Morevent. B.V.**
Chrysaanhemumlaan 9
2106 BM Heenstede

PROJECT : **Plattegronden**
Boeingavenue 285 (Gebouw B1)
Schiphol-Rijk

ONDERWERP	: Nem:550 Verdieping 2 Huurders	PROJECTNUMMER	BF2850-192
W.G. A		FILENNAAM (CAD)	192-756-H02
W.G. B		FORMAAT	A1
W.G. C	CP / SH	DATUM	SCHAL
W.G. D		SCHAAL	1:100
W.G. E			
W.G. F			

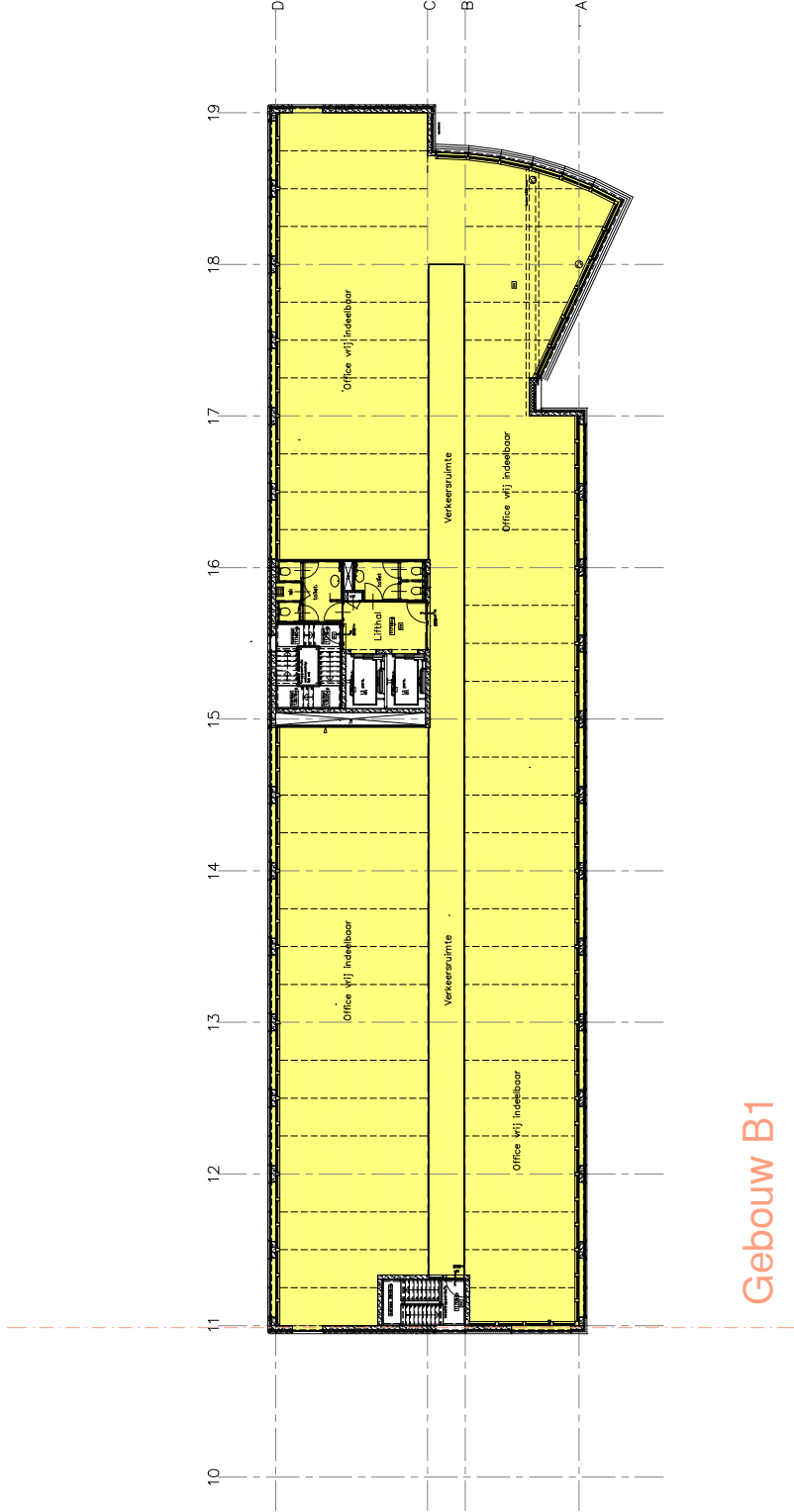

Gebouw B1

Plattegrond: Verdieping 3

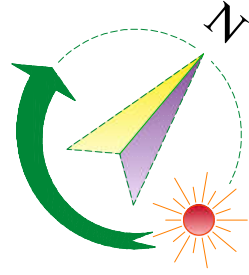

Toewijzing Primair oppervlak aan:

Huurder A	<input type="checkbox"/>	Gemeenschappelijke doorbelasting Gebouw (Ratio% Huurders)	<input type="checkbox"/>
Huurder B	<input type="checkbox"/>	Gemeenschappelijke doorbelasting verdieping (Ratio% Huurders)	<input type="checkbox"/>
Huurder C	<input type="checkbox"/>	Niet verhuurbaar deel gebouw	<input type="checkbox"/>
Huurder D	<input type="checkbox"/>		
Huurder E	<input type="checkbox"/>		
Huurder F	<input type="checkbox"/>		

Direct
 Ratio
 Geen

 Royal HaskoningDHV Enhancing Society Together		Meesterplaat M2 DE VERRIJME DIETER	
Leidscheerweg 4, Utrecht Postbus 2302, 3500 GE Utrecht (085) 484433 (tel) 085 484449 (mob) christina.peperkamp@dhv.com			
OPDRACHTGEVER : Morevent. B.V. Chrysaanhemumlaan 9 2106 BM Heenstede			
PROJECT : Plattegronden Boeingavenue 285 (Gebouw B1) Schiphol-Rijk			
ONDERNEEMER : Nem:850 Verdieping 3 Huurders		PROJECTNUMMER BF2850-192	
W.G. A W.G. B W.G. C W.G. D W.G. E W.G. F	NIEMAND ADRESSES CP / SH	FERRAAT AI	FEILNMAN (CAD) 192-756-103
DATUM 10-11-2023		SCHAAL 1:100	CERTIFICAAT NR: 756-H2

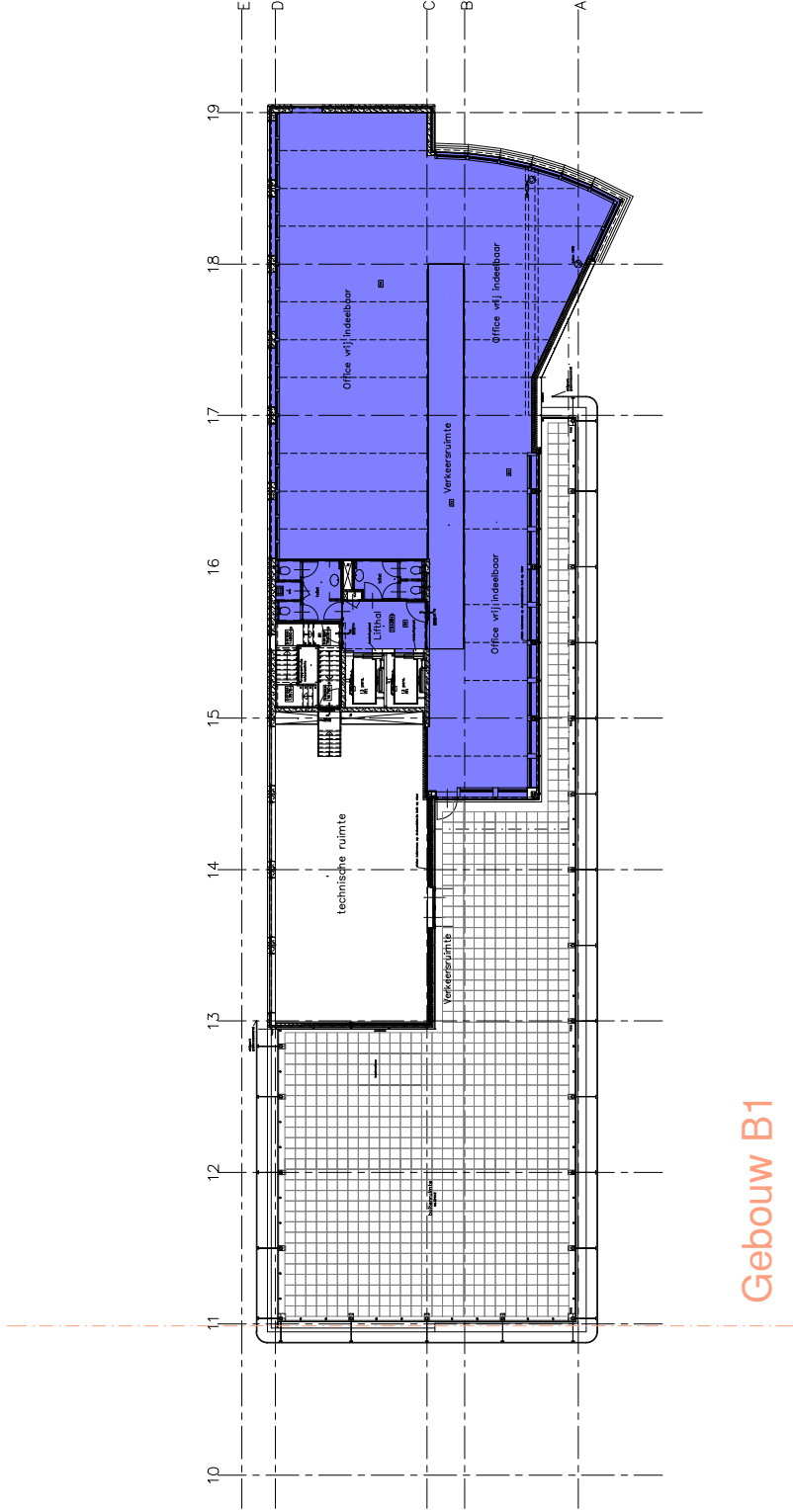

Gebouw B1

Plattegrond: Verdieping 4

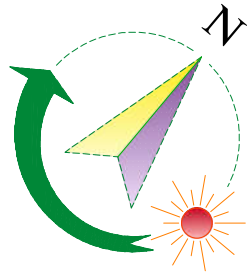

Toewijzing Primair oppervlak aan:

Huurder A	<input type="checkbox"/>	Gemeenschappelijke doorbelasting Gebouw (Ratio% Huurders)	<input type="checkbox"/>
Huurder B	<input type="checkbox"/>	Gemeenschappelijke doorbelasting verdieping (Ratio% Huurders)	<input type="checkbox"/>
Huurder C	<input type="checkbox"/>	Niet verhuurbaar deel gebouw	<input type="checkbox"/>
Huurder D	<input type="checkbox"/>		
Huurder E	<input type="checkbox"/>		
Huurder F	<input type="checkbox"/>		

Geen
 Direct
 Ratio

 Royal HaskoningDHV Enhancing Society Together		Meesterplaat 			
Leidschewer 4, Utrecht Postbus 2302, 3500 GE Utrecht (031) 84 44 33 (tel) 031 84 44 33 (fax) 031 84 44 33 (mob) d.h.v@rhdh.com					
OPRACHTGEVER : Morevent. B. V. Chrysaanhemumlaan 9 2106 BM Heenstede					
PROJECT : Plattegronden Boeingavenue 285 (Gebouw B1) Schiphol-Rijk					
ONDERNEEMER : Nem:850 Verdieping 4 Huurders					
WB. A	WB. G	WB. H	WB. I	WB. J	WB. K
WB. B	NEM:850 ADRESSES	WB. L	WB. M	WB. N	WB. O
WB. C	FERRAAT	WB. P	WB. Q	WB. R	WB. S
WB. D	CP / SH	WB. T	WB. U	WB. V	WB. W
WB. E	DATUM	WB. X	WB. Y	WB. Z	WB. AA
WB. F	10-11-2023	WB. AB	WB. AC	WB. AD	WB. AE
WB. G	1:100	WB. AF	WB. AG	WB. AH	WB. AI
WB. H		WB. AJ	WB. AK	WB. AL	WB. AM
WB. I		WB. AN	WB. AO	WB. AP	WB. AQ
WB. J		WB. AR	WB. AS	WB. AT	WB. AU
WB. K		WB. AV	WB. AW	WB. AX	WB. AY
WB. L		WB. AZ	WB. BA	WB. BB	WB. BC
WB. M		WB. BD	WB. BE	WB. BF	WB. BG
WB. N		WB. BH	WB. BI	WB. BJ	WB. BK
WB. O		WB. BL	WB. BM	WB. BN	WB. BO
WB. P		WB. BO	WB. BP	WB. BQ	WB. BR
WB. Q		WB. BS	WB. BT	WB. BU	WB. BV
WB. R		WB. BV	WB. BW	WB. BX	WB. BY
WB. S		WB. BZ	WB. CA	WB. CB	WB. CC
WB. T		WB. CD	WB. CE	WB. CF	WB. CG
WB. U		WB. CH	WB. CI	WB. CJ	WB. CK
WB. V		WB. CL	WB. CM	WB. CN	WB. CO
WB. W		WB. CP	WB. CQ	WB. CR	WB. CS
WB. X		WB. CT	WB. CU	WB. CV	WB. CW
WB. Y		WB. CX	WB. CY	WB. CZ	WB. CA
WB. Z		WB. CB	WB. CC	WB. CD	WB. CE
WB. AA		WB. CE	WB. CF	WB. CG	WB. CH
WB. AB		WB. CH	WB. CI	WB. CJ	WB. CK
WB. AC		WB. CI	WB. CJ	WB. CK	WB. CL
WB. AD		WB. CL	WB. CM	WB. CN	WB. CO
WB. AE		WB. CM	WB. CN	WB. CO	WB. CP
WB. AF		WB. CN	WB. CO	WB. CP	WB. CQ
WB. AG		WB. CO	WB. CP	WB. CQ	WB. CR
WB. AH		WB. CP	WB. CQ	WB. CR	WB. CS
WB. AI		WB. CQ	WB. CR	WB. CS	WB. CT
WB. AJ		WB. CR	WB. CS	WB. CT	WB. CU
WB. AK		WB. CS	WB. CT	WB. CU	WB. CV
WB. AL		WB. CT	WB. CU	WB. CV	WB. CW
WB. AM		WB. CU	WB. CV	WB. CW	WB. CX
WB. AN		WB. CV	WB. CW	WB. CX	WB. CY
WB. AO		WB. CW	WB. CX	WB. CY	WB. CZ
WB. AP		WB. CX	WB. CY	WB. CZ	WB. CA
WB. AQ		WB. CY	WB. CZ	WB. CA	WB. CB
WB. AR		WB. CZ	WB. CA	WB. CB	WB. CC
WB. AS		WB. CA	WB. CB	WB. CC	WB. CD
WB. AT		WB. CB	WB. CC	WB. CD	WB. CE
WB. AU		WB. CD	WB. CE	WB. CF	WB. CG
WB. AV		WB. CE	WB. CF	WB. CG	WB. CH
WB. AW		WB. CF	WB. CG	WB. CH	WB. CI
WB. AX		WB. CG	WB. CH	WB. CI	WB. CJ
WB. AY		WB. CH	WB. CI	WB. CJ	WB. CK
WB. AZ		WB. CI	WB. CJ	WB. CK	WB. CL
WB. BA		WB. CJ	WB. CK	WB. CL	WB. CM
WB. BB		WB. CK	WB. CL	WB. CM	WB. CN
WB. BC		WB. CL	WB. CM	WB. CN	WB. CO
WB. BD		WB. CM	WB. CN	WB. CO	WB. CP
WB. BE		WB. CN	WB. CO	WB. CP	WB. CQ
WB. BF		WB. CO	WB. CP	WB. CQ	WB. CR
WB. BG		WB. CP	WB. CQ	WB. CR	WB. CS
WB. BH		WB. CQ	WB. CR	WB. CS	WB. CT
WB. BI		WB. CR	WB. CS	WB. CT	WB. CU
WB. BJ		WB. CS	WB. CT	WB. CU	WB. CV
WB. BK		WB. CT	WB. CU	WB. CV	WB. CW
WB. BL		WB. CU	WB. CV	WB. CW	WB. CX
WB. BM		WB. CV	WB. CW	WB. CX	WB. CY
WB. BN		WB. CW	WB. CX	WB. CY	WB. CZ
WB. BO		WB. CX	WB. CY	WB. CZ	WB. CA
WB. BP		WB. CY	WB. CZ	WB. CA	WB. CB
WB. BQ		WB. CZ	WB. CA	WB. CB	WB. CC
WB. BR		WB. CA	WB. CB	WB. CC	WB. CD
WB. BS		WB. CB	WB. CC	WB. CD	WB. CE
WB. BT		WB. CC	WB. CD	WB. CE	WB. CF
WB. BU		WB. CD	WB. CE	WB. CF	WB. CG
WB. BV		WB. CE	WB. CF	WB. CG	WB. CH
WB. BV		WB. CF	WB. CG	WB. CH	WB. CI
WB. BW		WB. CG	WB. CH	WB. CI	WB. CJ
WB. BX		WB. CH	WB. CI	WB. CJ	WB. CK
WB. BY		WB. CI	WB. CJ	WB. CK	WB. CL
WB. BZ		WB. CJ	WB. CK	WB. CL	WB. CM
WB. CA		WB. CK	WB. CL	WB. CM	WB. CN
WB. CB		WB. CL	WB. CM	WB. CN	WB. CO
WB. CC		WB. CM	WB. CN	WB. CO	WB. CP
WB. CD		WB. CN	WB. CO	WB. CP	WB. CQ
WB. CE		WB. CO	WB. CP	WB. CQ	WB. CR
WB. CF		WB. CP	WB. CQ	WB. CR	WB. CS
WB. CG		WB. CQ	WB. CR	WB. CS	WB. CT
WB. CH		WB. CR	WB. CS	WB. CT	WB. CU
WB. CI		WB. CS	WB. CT	WB. CU	WB. CV
WB. CJ		WB. CT	WB. CU	WB. CV	WB. CW
WB. CK		WB. CU	WB. CV	WB. CW	WB. CX
WB. CL		WB. CV	WB. CW	WB. CX	WB. CY
WB. CM		WB. CW	WB. CX	WB. CY	WB. CZ
WB. CN		WB. CX	WB. CY	WB. CZ	WB. CA
WB. CO		WB. CY	WB. CZ	WB. CA	WB. CB
WB. CP		WB. CZ	WB. CA	WB. CB	WB. CC
WB. CQ		WB. CA	WB. CB	WB. CC	WB. CD
WB. CR		WB. CB	WB. CC	WB. CD	WB. CE
WB. CS		WB. CC	WB. CD	WB. CE	WB. CF
WB. CT		WB. CD	WB. CE	WB. CF	WB. CG
WB. CU		WB. CE	WB. CF	WB. CG	WB. CH
WB. CV		WB. CF	WB. CG	WB. CH	WB. CI
WB. CW		WB. CG	WB. CH	WB. CI	WB. CJ
WB. CX		WB. CH	WB. CI	WB. CJ	WB. CK
WB. CY		WB. CI	WB. CJ	WB. CK	WB. CL
WB. CZ		WB. CJ	WB. CK	WB. CL	WB. CM
WB. CA		WB. CK	WB. CL	WB. CM	WB. CN
WB. CB		WB. CL	WB. CM	WB. CN	WB. CO
WB. CC		WB. CM	WB. CN	WB. CO	WB. CP
WB. CD		WB. CN	WB. CO	WB. CP	WB. CQ
WB. CE		WB. CO	WB. CP	WB. CQ	WB. CR
WB. CF		WB. CP	WB. CQ	WB. CR	WB. CS
WB. CG		WB. CQ	WB. CR	WB. CS	WB. CT
WB. CH		WB. CR	WB. CS	WB. CT	WB. CU
WB. CI		WB. CS	WB. CT	WB. CU	WB. CV
WB. CJ		WB. CT	WB. CU	WB. CV	WB. CW
WB. CK		WB. CU	WB. CV	WB. CW	WB. CX
WB. CL		WB. CV	WB. CW	WB. CX	WB. CY
WB. CM		WB. CW	WB. CX	WB. CY	WB. CZ
WB. CN		WB. CX	WB. CY	WB. CZ	WB. CA
WB. CO		WB. CY	WB. CZ	WB. CA	WB. CB
WB. CP		WB. CZ	WB. CA	WB. CB	WB. CC
WB. CQ		WB. CA	WB. CB	WB. CC	WB. CD
WB. CR		WB. CB	WB. CC	WB. CD	WB. CE
WB. CS		WB. CC	WB. CD	WB. CE	WB. CF
WB. CT		WB. CD	WB. CE	WB. CF	WB. CG
WB. CU		WB. CE	WB. CF	WB. CG	WB. CH
WB. CV		WB. CF	WB. CG	WB. CH	WB. CI
WB. CW		WB. CG	WB. CH	WB. CI	WB. CJ
WB. CX		WB. CH	WB. CI	WB. CJ	WB. CK
WB. CY		WB. CI	WB. CJ	WB. CK	WB. CL
WB. CZ		WB. CJ	WB. CK	WB. CL	WB. CM
WB. CA		WB. CK	WB. CL	WB. CM	WB. CN
WB. CB		WB. CL	WB. CM	WB. CN	WB. CO
WB. CC		WB. CM	WB. CN	WB. CO	WB. CP
WB. CD		WB. CN	WB. CO	WB. CP	WB. CQ
WB. CE		WB. CO	WB. CP	WB. CQ	WB. CR
WB. CF		WB. CP	WB. CQ	WB. CR	WB. CS
WB. CG		WB. CQ	WB. CR	WB. CS	WB. CT
WB. CH		WB. CR	WB. CS	WB. CT	WB. CU
WB. CI		WB. CS	WB. CT	WB. CU	WB. CV
WB. CJ		WB. CT	WB. CU	WB. CV	WB. CW
WB. CK		WB. CU	WB. CV	WB. CW	WB. CX
WB. CL		WB. CV	WB. CW	WB. CX	WB. CY
WB. CM		WB. CW	WB. CX	WB. CY	WB. CZ
WB. CN		WB. CX	WB. CY	WB. CZ	WB. CA
WB. CO		WB. CY	WB. CZ	WB. CA	WB. CB
WB. CP		WB. CZ	WB. CA	WB. CB	WB. CC
WB. CQ		WB. CA	WB. CB	WB. CC	WB. CD
WB. CR		WB. CB	WB. CC	WB. CD	WB. CE
WB. CS		WB. CC	WB. CD	WB. CE	WB. CF
WB. CT		WB. CD	WB. CE	WB. CF	WB. CG
WB. CU		WB. CE	WB. CF	WB. CG	WB. CH
WB. CV		WB. CF	WB. CG	WB. CH	WB. CI
WB. CW		WB. CG	WB. CH	WB. CI	WB. CJ
WB. CX		WB. CH	WB. CI	WB. CJ	WB. CK
WB. CY		WB. CI	WB. CJ	WB. CK	WB. CL
WB. CZ		WB. CJ	WB. CK	WB. CL	WB. CM
WB. CA		WB. CK	WB. CL	WB. CM	WB. CN
WB. CB		WB. CL	WB. CM	WB. CN	WB. CO
WB. CC		WB. CM	WB. CN	WB. CO	WB. CP
WB. CD		WB. CN	WB. CO	WB. CP	WB. CQ
WB. CE		WB. CO	WB. CP	WB. CQ	WB. CR
WB. CF		WB. CP	WB. CQ	WB. CR	WB. CS
WB. CG		WB. CQ	WB. CR	WB. CS	WB. CT
WB. CH		WB. CR	WB. CS	WB. CT	WB. CU
WB. CI		WB. CS	WB. CT	WB. CU	WB. CV
WB. CJ		WB. CT	WB. CU	WB. CV	WB. CW
WB. CK		WB. CU	WB. CV	WB. CW	WB. CX
WB. CL		WB. CV	WB. CW	WB. CX	WB. CY
WB. CM		WB. CW	WB. CX	WB. CY	WB. CZ
WB. CN		WB. CX	WB. CY	WB. CZ	WB. CA
WB. CO		WB. CY	WB. CZ	WB. CA	WB. CB
WB. CP		WB. CZ	WB. CA	WB. CB	WB. CC
WB. CQ		WB. CA	WB. CB	WB. CC	WB. CD
WB. CR		WB. CB	WB. CC	WB. CD	WB. CE
WB. CS		WB. CC	WB. CD	WB. CE	WB. CF
WB. CT		WB. CD	WB. CE	WB. CF	WB. CG
WB. CU		WB. CE	WB. CF	WB. CG	WB. CH
WB. CV		WB. CF	WB. CG	WB. CH	WB. CI
WB. CW		WB. CG	WB. CH	WB. CI	WB. CJ
WB. CX		WB. CH	WB. CI	WB. CJ	WB. CK
WB. CY		WB. CI	WB. CJ	WB. CK	WB. CL
WB. CZ		WB. CJ	WB. CK	WB. CL	WB. CM
WB. CA		WB. CK	WB. CL	WB. CM	WB. CN
WB. CB		WB. CL	WB. CM	WB. CN	WB. CO
WB. CC		WB. CM	WB. CN	WB. CO	WB. CP
WB. CD		WB. CN	WB. CO	WB. CP	WB. CQ
WB. CE		WB. CO	WB. CP	WB. CQ	WB. CR
WB. CF		WB. CP	WB. CQ	WB. CR	WB. CS
WB. CG		WB. CQ	WB. CR	WB. CS	WB. CT
WB. CH		WB. CR	WB. CS	WB. CT	WB. CU
WB. CI		WB. CS	WB. CT	WB. CU	WB. CV
WB. CJ		WB. CT	WB. CU	WB. CV	WB. CW
WB. CK		WB. CU	WB. CV	WB. CW	WB. CX
WB. CL		WB. CV	WB. CW	WB. CX	WB. CY
WB. CM					